

DWG. NO.

A076-150x90-Facta

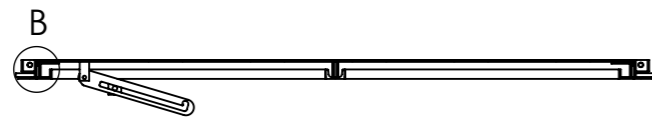

SECTION A-A

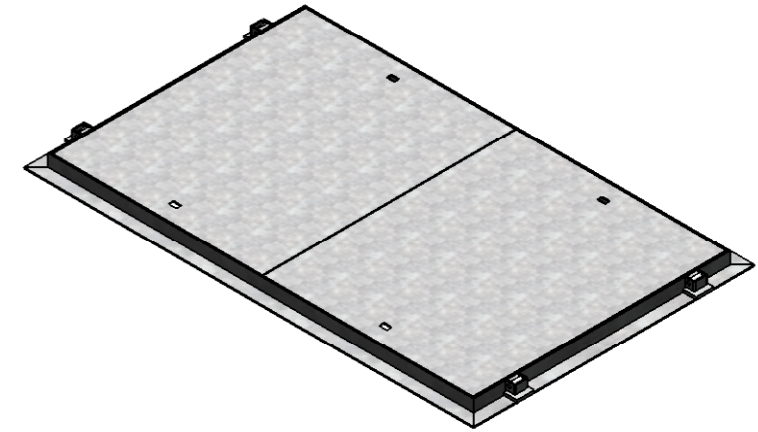
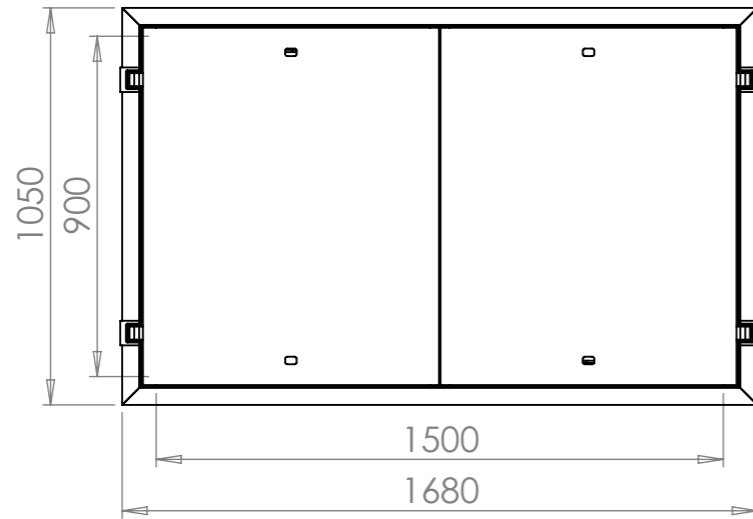
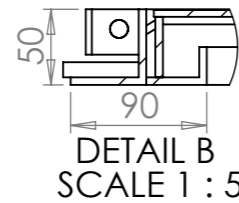
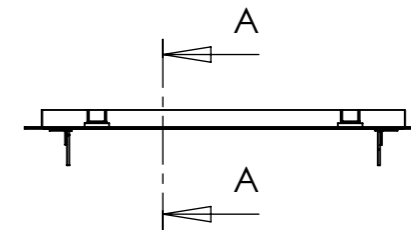

DETAIL B
SCALE 1 : 5



Unit 3 Power Park, Towers Business Park, Rugeley, Staffs. WS15 1UZ
Telephone 01889 572620 Fax 01889 572629
Email sales@aquacastltd.com

Customer:



A3

Description: 1500x900 Twin Hinged C&F

| | Name | Date | Material: | Mild Steel |
|-------------|--------------------|------------|-------------|------------------|
| Drawn By: | Sandy Mcfie-Hyland | 11/05/2009 | Finish: | Galvanised Steel |
| Checked By: | Steve Hulse | 11/05/2009 | Loading: | Facta |
| Scale: | 1:20 | | Weight(kg): | 107.74 |