

**DWG. NO.**

A092-150x150-Facta

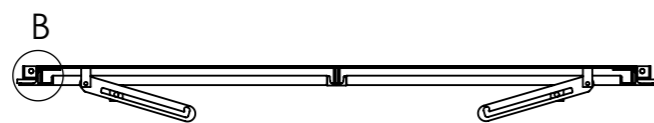

SECTION A-A

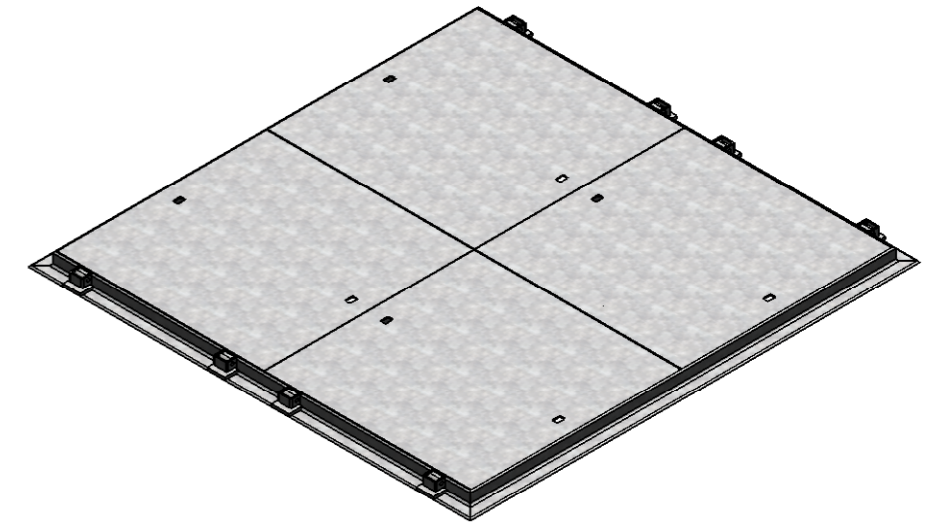
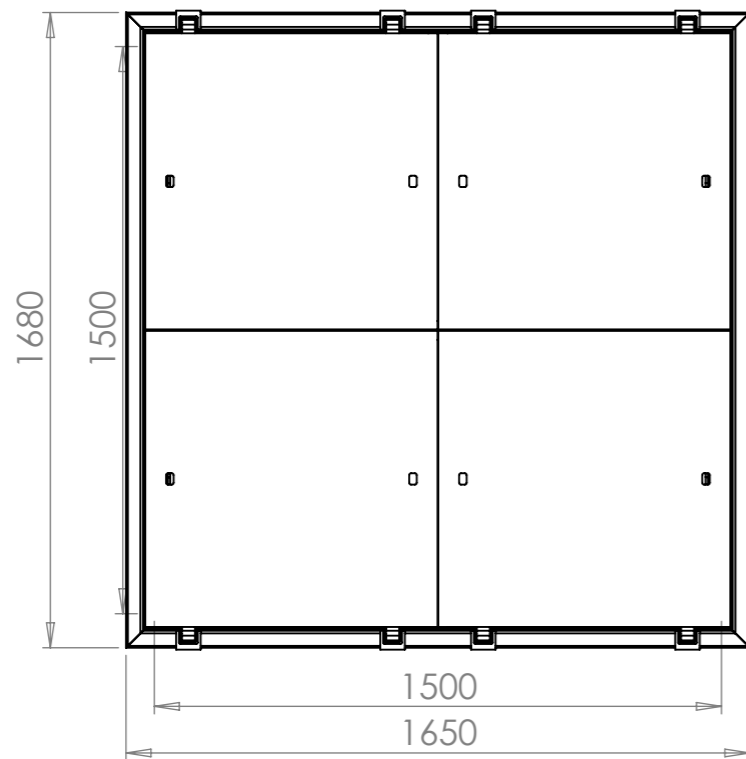
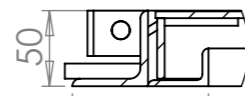

DETAIL B  
SCALE 1 : 5

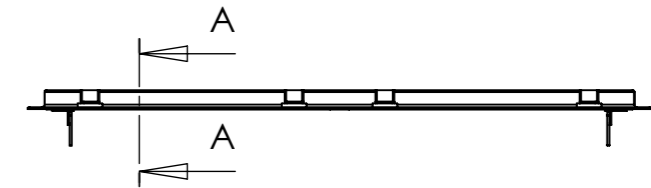

Unit 3 Power Park, Towers Business Park, Rugeley, Staffs. WS15 1UZ  
Telephone 01889 572620 Fax 01889 572629  
Email sales@aquacastltd.com

Customer:



**A3**

Description: 1500x1500 Multiple Hinged C&F Facta

	Name	Date	Material:	Mild Steel
Drawn By:	Sandy Mcfie-Hyland	11/05/2009	Finish:	Galvanised Steel
Checked By:	Steve Hulse	11/05/2009	Loading:	Facta
Scale:	1:20		Weight(kg):	174.99